

Ratings/Slope
East/West 67.0/111
North/West 68.5/113
North/East 67.5/112

Fairways									
Yellow 200 Yds									
Green - 150 Yds									
Par - 100 Yds									
1	2	3	4	5	6	7	8	9	
296	164	400	405	195	430	351	289	326	2856
291	149	362	393	178	414	339	280	318	2744
4	3	4	5	3	4	4	4	4	35
6	9	2	3	8	1	3	7	7	4
HANDICAP									
HOLE NUMBER									
1	2	3	4	5	6	7	8	9	TOT
YELLOW TEE									
296	164	400	405	195	430	351	289	326	2856
291	149	362	393	178	414	339	280	318	2744
4	3	4	5	3	4	4	4	4	36
6	9	2	3	8	1	3	7	7	4
HANDICAP									
HOLE NUMBER									
1	2	3	4	5	6	7	8	9	TOT
GREEN TEE									
312	333	345	395	346	432	155	353	316	3187
303	525	330	383	332	390	144	358	311	3066
4	5	4	5	4	4	3	4	4	36
8	7	1	5	2	6	3	9	4	7
HANDICAP									
HOLE NUMBER									
1	2	3	4	5	6	7	8	9	TOT
YELLOW TEE									
291	426	313	270	318	318	133	322	306	2773
4	5	4	4	4	5	3	4	4	37
7	1	4	4	4	5	2	9	3	6
HANDICAP									
HOLE NUMBER									
1	2	3	4	5	6	7	8	9	TOT
GREEN TEE									
401	209	586	411	511	166	346	359	356	3345
370	161	553	337	201	371	130	327	334	3114
4	3	5	4	5	3	4	4	4	36
4	8	1	3	2	9	7	6	5	9
HANDICAP									
HOLE NUMBER									
1	2	3	4	5	6	7	8	9	TOT
YELLOW TEE									
333	157	403	296	424	101	390	309	333	3718
4	3	5	4	5	3	4	4	4	36
4	8	2	3	1	9	7	6	3	3
HANDICAP									

Course Map

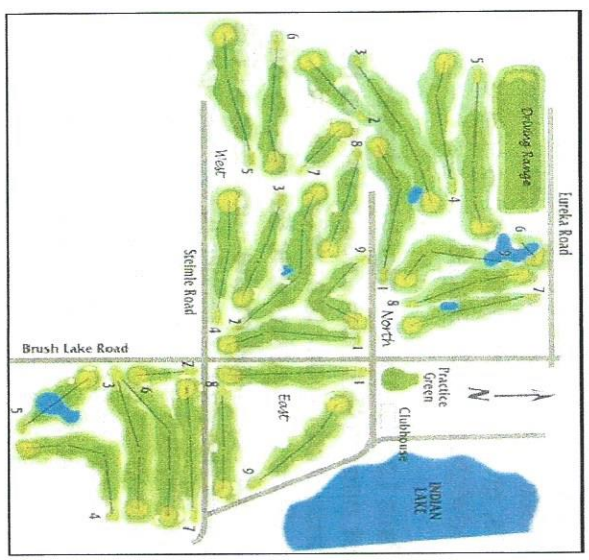

Driving Map

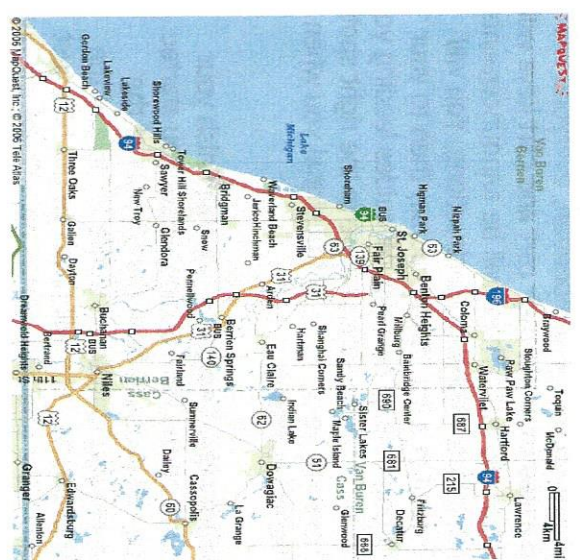

GOLF OUTTING INFO

55321 Brush Lake Road
 Eau Claire, MI 49111
 269.782.2540
indianlakehills.com
golf@indianlakehills.com

Steve & Lynn Miller
 John & Suzie Vanderburg

Thank you for choosing Indian Lake Hills
 Hope you have a great time, a safe trip
 home and we look forward to seeing you
 again!!

Welcome to Indian Lake Hills Have Fun!!

Don't forget ~ to bring the right equipment and be prepared for the weather; Golf clubs, balls, tees, divot tool, ball markers, proper shoes (soft spikes or soft soles), extra socks, sunscreen, rain gear and towel.

Warm up at the Range ~ located off of Eureka Road. It is not accessible with a cart; therefore you must pick up balls in the clubhouse and drive to the range unless arrangements are made to have balls ready there for you. You will need to allow time to check in and load up on your assigned cart.

Unloading and Loading ~ Golf carts will be lined up and tagged with your name and tee assignment. You will not be allowed to move your cart any time before the shotgun procession onto the course. Guests will get their bags to their carts. You may want to designate a bag drop area or recruit bag runners/volunteers to help guests with bags.

Checking In ~ You will be received by your hosts at the registration tables set up in front of the clubhouse. Please allow time to check your group in. This will be "home base" prior to teeing off. You will receive your event tickets, goodie bags and or contest rules. You may have an opportunity to sign up for skin games, purchase mulligan's or raffle tickets.

Last Minute Checklist ~ Once your group has found their carts and has loaded your equipment; it is time head to the pro

shop/clubhouse. Continental style breakfast is available in the clubhouse; it may be included in your event and will be set up on the pavilion. The pro shop has last minute items for sale if you need gloves, socks, umbrellas, balls, etc. The clubhouse bar has snacks, sandwiches and beverages.

State Law prohibits alcoholic beverages not purchased from Indian Lake to be consumed on our property. We will confiscate any alcoholic beverages and may be returned to the customer at the end of the day. Alcoholic beverages are available in the clubhouse bar and are sold by the beverage cart on the course. Beer is sold by the can or by the six-pack with ice. Coolers are available with a refundable \$10 deposit. We do not allow outside coolers on the course without a thorough inspection.

Heading Up and Moving Out ~ After you have sized up the competition, everyone will be asked to get in their cart and cart keys will be handed out. There will be announcements with introductions and instructions. You will proceed in a line to the course, then to your starting hole. There will be guides leading you out and making sure you are in the right spot. There will be a big BOOM to signal you when to start swinging.

Follow the Leader ~ You will finish your round on the hole behind where you started. You will proceed from the 9th hole of the course you started on to the 1st hole of the other course. You will finish on the hole just before the one you started on. There will be course rangers on the course assisting you.

Pace of Play ~ KEEP UP WITH THE GROUP AHEAD OF YOU. Timing is important when there is food and awards at the end of the event. Our staff is trained to assist players tactfully. You may be asked to pick up your pace and or pick up and move to the next open hole if your group falls behind the group ahead of you. There will be plenty of time to socialize at the end of the round.

Contests and Fun ~ There will be contest markers on the course. Long drive markers will be in the fairway. Closest to the pins, longest putt, closest second shot will be on the greens. If your shot is better than the one marked, put your name under the listed name and replace the marker to your spot.

On Course Service ~ There may be beverage carts on the course selling snacks, sandwiches, and beverages. All sales are cash, unless you arrange a credit card tab in the clubhouse.

Heading In ~ When you have finished your round be careful when coming off the course, as there may still be some groups playing. Leave markers on the course. Staff will be out to pick them up later. You can drive to your car and unload your clubs and personal belongings. Take carts to the Cart Return area where staff will be waiting.

The 19th Hole ~ You have the hard part over ... DON'T forget to turn in your card—with the total added. Now it is on to collect all your winnings and socialize with the gang. Dinner and drinks will be ready and waiting for you.